

# Vandal-proof Combination Unit SLWN 08L



## Characteristics



- **vandal-proof**
- **suitable for prison**
- corner combination with toilet, washbasin and washbasin spout
- push button for washbasin spout
- push button for toilet flushing
- floor standing toilet on the left side
- filled with expanded polyurethane (to avoid dents and typical metal noise)
- **rear assembling by screws (M10, length 190 mm), from the service room**
- material stainless steel AISI 304 (1.4301)
- brushed finish

## Dimensions

SERVICE  
ROOM CELL

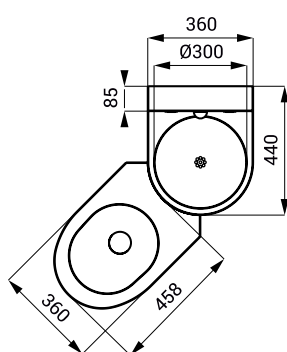
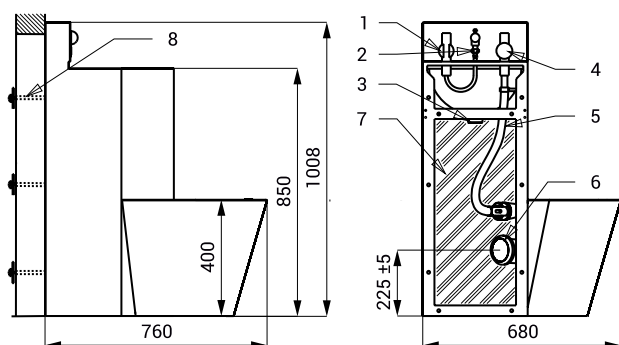

## Technical Specification

<b>Dimensions</b>	1008 x 760 x 680 mm
<b>Weight</b>	29 kg
<b>Recommended flow pressure</b>	0,15 - 0,5 MPa
<b>Rate of flow</b>	70 l/min. by the pressure 0,15 MPa (inf. data)
<b>Water inlet</b>	
▪ WC	Ø min. 32 mm (PN 16) male thread G 3/4"
▪ washbasin	male thread G 1/2"

- 1 - push button for washbasin - male thread G 1/2"
- 2 - washbasin spout
- 3 - waste outlet pipe from the washbasin - male thread G 6/4"
- 4 - push button for toilet - male thread G 3/4"
- 5 - toilet flushing valve
- 6 - waste outlet connection from toilet (Ø 101,6 mm)
- 7 - filled with expanded polyurethane
- 8 - M10 screw (length 190 mm) + anchor + nut (6 pcs.)

## Supply Specification

**SLWN 08L - Supply No. 94081** stainless steel combination unit with toilet and washbasin, push button (2 pcs.), washbasin spout, screws M10 (6 pcs.), set for connection